

adventure, inspired by

AIRSTREAM

EUROPEAN TRAVEL TRAILERS





INSPIRING ADVENTURE FOR OVER 80 YEARS.

In 1931 Airstream began with Wally Byam's dream of creating lightweight travel trailers that slipped cleanly through the wind. The fulfilment of this dream led to further dreams of freedom, distant places, new experiences and new friendships. This vision was so powerful and enduring that it did far more than create a new way of travel; it soon led to a new way of life.

Our latest Airstream fleet continues the tradition of extraordinary design and hand-crafted quality that has made Airstream world famous. Following our founder's credo, "Let's not make changes, let's only make improvements," all models offer the latest technological advancements and meet all of your expectations for comfortable caravanning. With travel trailers perfect for everyone from first-timers to seasoned Airstreamers, you're sure to find one ideal for the adventure that awaits you around the next bend!



Bob Wheeler
President
Airstream, Inc.



AN ENVIRONMENTALLY FRIENDLY INVESTMENT

Airstream has been green as long as it has been silver. This is because few things in life have proven to be as durable. Over the years only a few products have been able to match this quality. In fact, nearly 70 % of all Airstreams ever built since 1931 are still in use today. This legendary longevity has resulted in Airstream's extraordinary value retention and resale price.

They serve their owners well, down from generation to generation. Should your Airstream come to the end of its life after many decades of service, its primary components (such as aluminium, steel and wood) are all easily recyclable. In our environmentally conscious world of today, Airstreams are still the perfect companion for chasing dreams of travel, pursuing the moment and enjoying a broad and expansive life.

Adventure, inspired by Airstream.



*"Adventure is everywhere,
except at home in your
rocking chair."*

Wally Byam

The history of the caravan cult

More than 80 years ago the American Wallace Merle Byam created his own unique lifestyle - and thereby became the founding father of the Airstream myth. Being the enthusiastic free spirit that he was, he loved camping. In 1929 Wally bought the chassis of a Ford Model T and at a camp site in the Blue Mountains mounted his tent on the platform. Yet Wally's wife found the tent contraption too uncomfortable. In order to make her life more comfortable during trips, he tinkered around and came up with a permanent shelter made out of plywood and canvas. The result was tear-drop-shaped, aerodynamic and included a kerosene stove as well as a refrigerator. The enterprising inventor sold the manual for building his caravan for a dollar a copy. His idea earned him a total of more than 15,000 dollars. In 1932 the first completed caravans were available for sale.

On the way from the first Airstream to serial production in his own company Wally had to pass some milestones. These greatly influenced the design of his Airstream. First he bought the Bowlus-Teller Trailer Company that designed its caravans like aeroplanes. The "Airstream Clipper" made its debut, with its monocoque construction out of aluminium tubing, covered with riveted aluminium panels - a homage to the "Pan Am Clipper" aeroplanes that were famous at that time.

However, the 2nd World War brought production to an end, because aluminium was no longer available for civilian purposes. The visionary Wally Byam used this challenge as an opportunity. He found a job at Curtiss-Wright, an aeroplane manufacturer. Once again, inspired by aeronautics, Wally introduced additional improvements to his caravan. However, due to differences of opinion, he left the company and founded Airstream Trailer Inc..

What Wally had in mind, was not just a product, but rather his own way of life. He showed just what he meant in 1951 when he undertook his world famous caravan expedition. For four months 63 vehicles trundled through Central America. This was followed by worldwide trips, as for example in 1956 through Europe. A total of 38 Airstreams toured 18 countries on the continent in which the Iron Curtain had just made its appearance. The later tour from Cape Town to Cairo in 1959 may well be considered the culmination of the caravans. Also referred to as torture tests for the Airstreams, defects that manifested themselves during the trip were promptly reported to the plant. Of course the tours generated good publicity, something a businessman also knows how to put to use. Yet, for Wally it was not just a business matter. He wanted to experience adventure and the world and to discover other cultures. In this vein he once remarked, "In the countries that we visited we created more goodwill than all of the diplomats with their fancy suits."

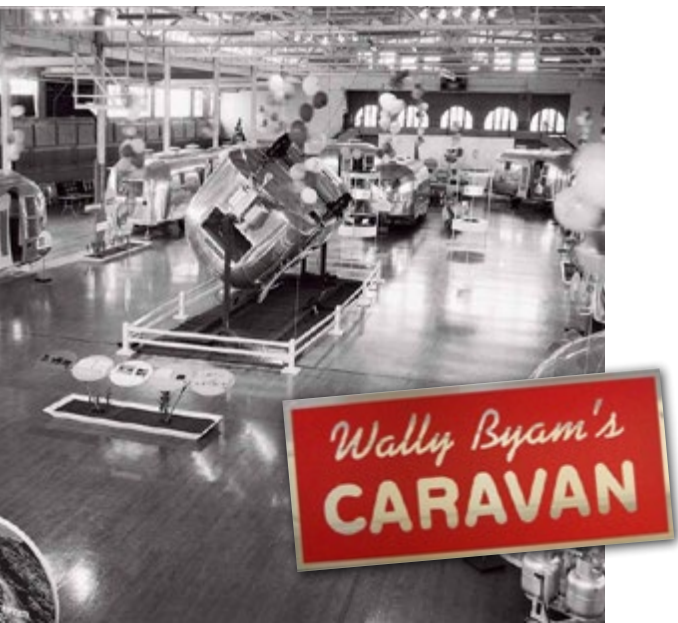

With the founding of the Wally Byam Caravan Club in 1955, the cornerstone for the Airstream cult was finally laid. Owners of the silver bullets are not just travellers, but Airstreamers living their dream. By the middle of the eighties the club had around 24,000 adventure-hungry members. Wally Byam did not live to experience this hey day. He died on 22 July, 1962.

Even today each Airstream is made according to the rules of old-fashioned craftsmanship. The result is a lighter and more stable construction that, in addition to the challenges of the streets of this world, can also stand the hardest test of all - time.



*"I name it Airstream.
Because it glides over
the highways like a
puff of air."*

Wally Byam





A TRUE DESIGN ICON

One look at an Airstream and you know exactly what it is for: it's meant to be lived in, it's meant to be travelled in, it's meant to help people discover their world in a unique way that transcends its functionality. Eight decades after its introduction, art historians and design experts are still enthusiastic about its appearance, about its simplicity and its nonetheless emotionally appealing design. An Airstream embodies a special attitude to life and combines luxury and timeless design in a way that no other vehicle can match.

For generations many designers, architects and visionary owners have created their own Airstream based on their personal taste in materials, colours, and usability.

Yet an Airstream always remains an original, because from the very beginning it is a unicom specially created by craftsmanship.

An Airstream stands for the quest for freedom and independence and attracts people who want to explore the world. People who don't know what's over the next horizon, but who definitely want to experience it. People who want to experience the adventure of Airstream travel. That is the myth that binds all Airstreamers with one another.





**BETTER AERODYNAMICS
RESULT IN LESS WEAR AND TEAR**

AERODYNAMIC AND FUEL-EFFICIENT

The design that makes an Airstream so unique results in about 20% less fuel consumption than a typical white box caravan. Many decades ago, Airstream founder Wally Byam was already aware that this design offered clear advantages in regard to aerodynamics, crosswind sensitivity and tracking stability. Today these features are more important than ever because they help save gas and to create increased security while towing caravans.

**SLIGHT CROSSWIND SENSITIVITY AND
A LOW CENTRE OF GRAVITY CREATE
OPTIMAL STABILITY**



Airstream travel trailers are world-renowned for their light, semi-monocoque construction, consisting of an inner and outer layer of aluminium stretched and hand-riveted to the frame with thousands of rivets. This unique manner of construction creates structural integrity and strength combined with reduced weight and durability.



UNIQUE DESIGN

The design of an Airstream is unique in the industry. Not just because of the top quality materials that are used, but also due to the production process that each Airstream undergoes.

During the first step a light but stable aluminium frame is covered with aircraft-grade aluminium coated with transparent varnish that is then hand-riveted to the frame. After installation of the windows the outer shell of the chassis is mounted. Before this takes place the inside panelling of the trailer is tested in a weather chamber for leak tightness. The standard therefor is a category 2 hurricane. Using this method Airstream quality control can find possible leaks and permanently eliminate them. Other manufacturers only test their vehicles after they have been fully constructed and equipped. This makes it difficult to identify and eliminate leaks in a reliable fashion, especially if these are hidden behind components that have been installed. After being successfully tested for leak tightness, the wiring harness is inserted and the vehicle is insulated with glass padding.

After the interior panelling is assembled the interior fittings and fixtures are introduced. All furnishings and devices are brought in through the door of the vehicle. Looked at in the reverse, this means that anything to be serviced or exchanged can easily be reached and, if necessary, removed through the door.

To be sure, this production process involves more work and is also more expensive than in the case of mass-produced vehicles in which the furniture is partially installed on the platform in entire blocks and then the walls are added at the end. This time-consuming manner of building an Airstream is one of the main reasons why so many vehicles from the last 80 years still exist and are used today. In an Airstream almost everything is replaceable - all the way from the shell to the inside.

AIRSTREAM EUROPEAN TRAVEL TRAILERS

ADVENTURE, INSPIRED BY AIRSTREAM.





FLOORPLANS

534 European Bambi

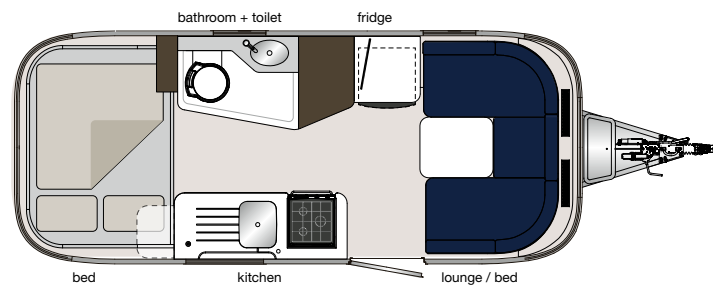

DATA

Sleeping capacity: 4
Body length: 5.30 m
Total length: 6.80 m
Width: 2.30 m

TOWING VEHICLE

sedan / station wagon / SUV
min. 1.800 kg towing capacity

684 Our top model – the Land Yacht

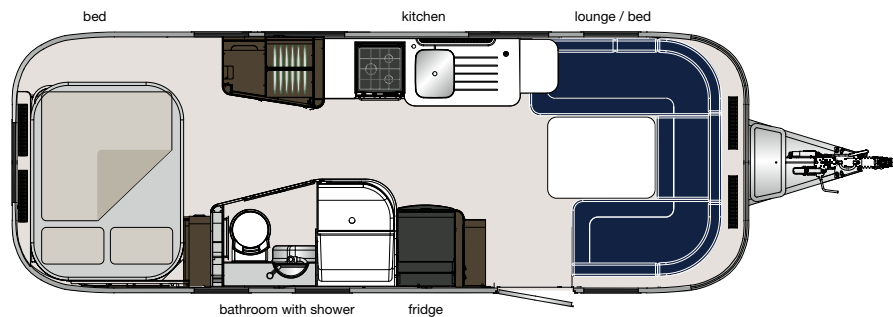

DATA

Sleeping capacity: 4
Body length: 6.80 M
Total length: 8.25 M
Width: 2.50 M

TOWING VEHICLE

SUV / 4x4
min. 2.700 kg towing capacity

251B Queens-Bed and luxury bathroom

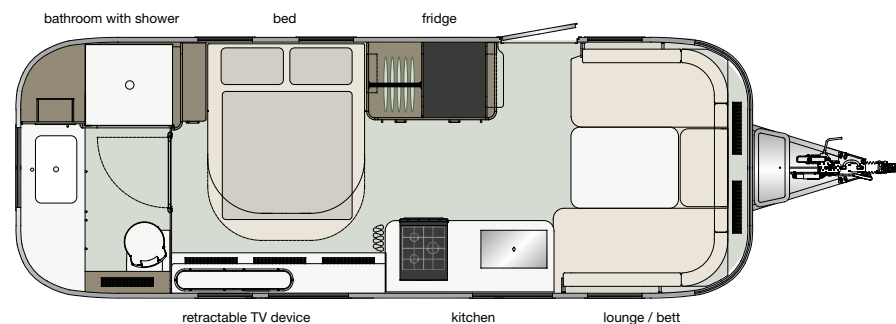

DATA

Sleeping capacity: 4
Body length: 6.80 M
Total length: 8.25 M
Width: 2.50 M

TOWING VEHICLE

SUV / 4x4
min. 3.000 kg towing capacity

ALL INFORMATION AND CURRENT MODELS ONLINE

You will find detailed information concerning floor plans, options, and the quickest way to get in touch with your Airstream dealer at www.airstream-germany.de

534 INTERNATIONAL



THE EUROPEAN BAMBI

AIRSTREAM INTERNATIONAL 534

Leave home without leaving the comforts of home behind! With the **Airstream 534** we made no compromises in order to offer you the comfort that you are accustomed to. Regardless of whether you are seeking to entertain, wanting to eat in a pleasant environment, or simply wishing to relax - no other caravan offers the incomparably comfortable and luxurious surroundings of an Airstream.

The **Airstream 534** is a compact caravan and offers a fixed bed to the rear and a wrap-around front lounge in the front that converts into a second double bed. The standard equipment includes a complete kitchen with refrigerator, a 3-burner stove with an oven and an extractor hood. The full bathroom with WC and shower screen makes the use of public facilities unnecessary.

▼ Full designer bathroom unit with WC

The standard, programmable central heating provides comfortable warmth at external temperatures all the way to -20° C and the optional air conditioner ensures a comfortable temperature range during summer. Other options include a Corian sink cover, awnings, flat screens and automated manoeuvring assistance, all of which can be combined as desired.



534 INTERNATIONAL





684 INTERNATIONAL



AIRSTREAM INTERNATIONAL 684

The **Airstream 684** is the ultimate travel trailer of the Airstream Europe series. With a body length of 6.8 metres, it offers a generous space for up to four people. The bathroom with shower stall and WC impresses with its many details such as heatable hand towel holders and a lit shaving and make-up mirror. The stunning interior includes the most modern technology, high-grade materials, and well thought-out detailed solutions for perfect

use. The standard kitchen is equipped with a 3-burner stove, a refrigerator with a freezer compartment, a microwave as well as an extractor hood. As in all models, the **Airstream 684** ensures a comfortable temperature with its Alde central heating system. The coloured LED control panel provides information at any time about the most important functions on board, as e.g. fresh water supply, battery charge level and energy consumption.

▼ U-shaped lounge that can be converted into a bed, optionally available in different leather colours or fabric.

With the help of an optionally installed 12 volt gas generator you can transform your **Airstream 684** into a caravan that is essentially independent of electricity and with which you can travel for several days without the necessity of an electrical hookup.

Many further optional features such as air conditioning, automated manoeuvring assistance, flat screens and a satellite dish system turn your **Airstream 684** into a unique travel caravan, the use of which does not require that you do without any luxury.



684 INTERNATIONAL

▼ Complete bathroom with WC, shower stall,
sink and make-up mirror



▲ Front lounge with
red leather



◀ Splendidly equipped
kitchenette with stove,
oven and extractor hood



25IB INTERNATIONAL



AIRSTREAM INTERNATIONAL 25 ISLAND BED

The **Airstream International 25IB** combines American style with European technology into an exciting new floor plan. Find out how a 17 m² can be turned into an opulent space that feels significantly larger. Light grey cabinets, bright surfaces and dark wooden contrasts are complemented by a woven vinyl floor to create an a modern and comfortable ambience. The kitchen comes standard with a 3-burner stove and a refrigerator with

freezer compartment. The powerful Aircondition helps to keep the Airstream cool during hot summer days and the hydronic central heating system generates cosy warmth in the cold season of the year. This makes the **Airstream International 25IB** perfectly suited for use in summer or winter. An LCD control panel constantly provides information about your tank capacities, battery level and power consumption.

A particular highlight of this Floorplan is the spacious rear bathroom. It offers a comfortable vanity with plenty of space, a ceramic toilet, and a generous shower stall – almost like home.

Just as all other Airstreams, the International 25IB can be tailored to your personal requirements by choosing from a wide range of options such as the manoeuvring systems, satellite antennas, TVs and a range of upholstery options.



25IB INTERNATIONAL

The comfortable kitchenette provides easy access and is equipped as standard with a Corian worktop and a large stainless steel sink. Meals are prepared on a three-burner gas stove with oven. The ingredients are stored in a large-volume coolerfreezer combination. Dishes and silverware can be stowed safely and neatly in one of the many drawers and cabinets. ▼



▲ Utilizing the entire width of the caravan, the expansive bathroom offers a 70 x 74 cm shower stall along with a vanity and toilet that are each made of ceramic.



A unique feature is the island bed that can be accessed from both sides thanks to its arrangement in the middle of the vehicle. Sophisticated technology makes it possible to shorten the bed or raise its head section electrically. This lets the bed function as a comfy TV couch during the day and keeps the passageway to the bathroom clear. Located at the foot of the bed is a large retractable TV cabinet with enough room to house 32" TV. ►



AIRSTREAM EUROPEAN TRAVEL TRAILERS

ADVENTURE, INSPIRED BY AIRSTREAM.







THE RESTLESS SPIRIT...

An Airstream fascinates everyone driven by an insatiable desire to see more, to do more, to simply live more fully. It attracts everyone who knows the lure of the open road and who can't wait to see what the world holds for them around the next bend. Airstream connects with every person who treasures both independence and an inspiring design. And naturally also those who can recognise the quality and craftsmanship that has enabled Airstream to pass the hardest test of all - time.

Adventure, inspired by Airstream.

Tywyn, Wales, Great Britain



ADVENTURE, INSPIRED BY AIRSTREAM.

BOONDOCKING WITH A CARAVAN?

Absolutely, Airstream caravans are in no way inferior to Motorhomes when it comes to self-sufficiency. Many of our customers are exclusively using their private bathroom while on the road.

Our standard specification allows you to be independent from electricity and water for supply for up to 3 days. For longer off the grid trips, customers can choose to add solar panels, onboard generators and bigger tanks as well as alternative toilet solutions.



Plage de Piemanson, Carmargue, Frankreich



AIRSTREAM EUROPEAN TRAVEL TRAILERS

ADVENTURE, INSPIRED BY AIRSTREAM.





Camping Seiser Alm, Südtirol, Italien



COLD ON THE OUTSIDE - SNUGGLY WARM ON THE INSIDE

*All our European models come standard
with a central hydronic heating system.
This system produces silently a pleasant
warmth even if outside temperatures
drop as low as -20 degrees Celsius*



Underway to the Arctic Circle, Sweden

ADVENTURE...

For over 80 years Airstream caravans have inspired their owners to discover the world.

When will your trip begin?



...inspired by

 **AIRSTREAM**



**ITCHY FEET AND A THIRST
FOR ADVENTURE?**

We look forward to your visit at our
showroom in Merenberg.

AIRSTREAM
Service Centre & Showroom
Boschstraße 4
35799 Merenberg
T 0 64 71 - 50 88 80

**We kindly ask that you make an
appointment over the phone.**

Our service centre with workshop and
showroom will be happy to attend to your
repair and equipment needs and to any
special requests you may have.

